

1 CH. 0.75x45° All over 2 All dimensions are in mm 3 If in doubt, please ask 4 Remove sharp corners 5 8

FOR APPROVAL

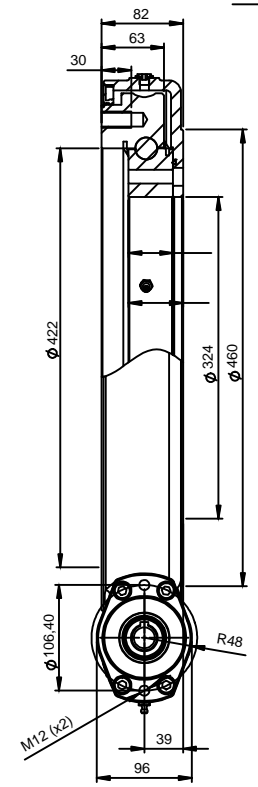
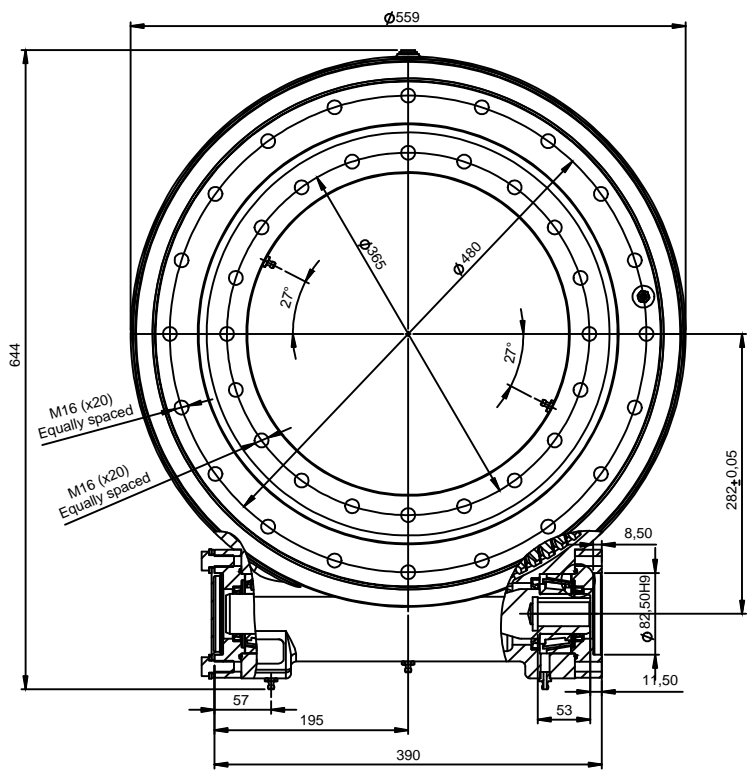
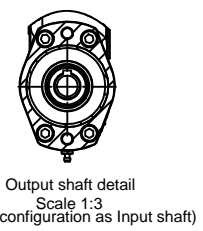
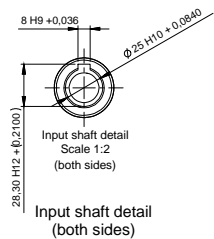

Note: Minimum input torque: 25Nm

Main performance parameters

Gear Ratio	103:1	Holding torque	55kNm
Efficiency	40%	Tilting moment	111,6kNm
Self-locking gear	Yes	Radial static load	413kN
Backlash clearance	<0,17°	Axial static load	1107kN
Maximum torque	15.600Nm	Radial dynamic load	170kN
Nominal torque	14.700Nm	Axial dynamic load	198kN

Notes: All stew drive are pre-lubricated. Maximum output speed 1rpm.

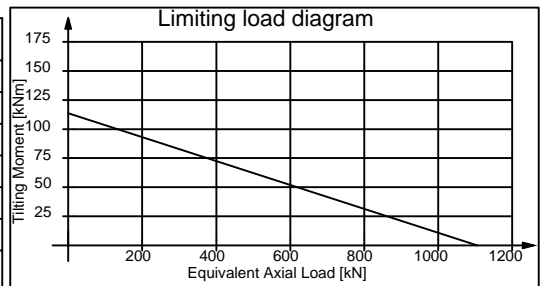

<p>KAVITSU GROUP OF INDUSTRIES</p>						Customer-Standard			Issued to -					
	Rev. no.		Revision note		Date	Signature	Checked	Limits	Designed by ARS	Checked by KVP	Approved by - date VGP	Date 06.06.2022	Material -	Weight @105 Kgs.
	KAVITSU ROBOTRONIX Pvt.Ltd.Satara								Model Description SD-114-22-0422-FF		Layout no. KRPL-SD-011		Qty. - 01 nos.	
												Edition 0	Sheet 1/1	