

1 2 3 4 5 6 7 8
 CH. 0.75x45° All over All dimensions are in mm If in doubt, please ask Remove sharp corners

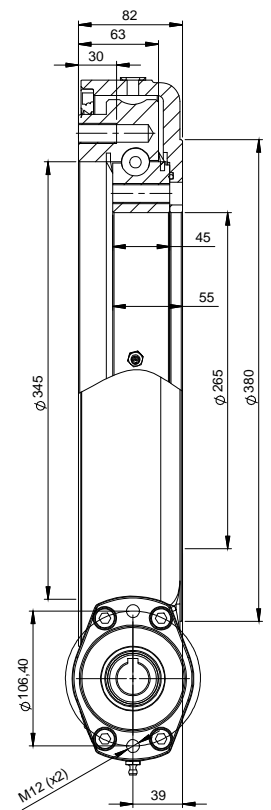
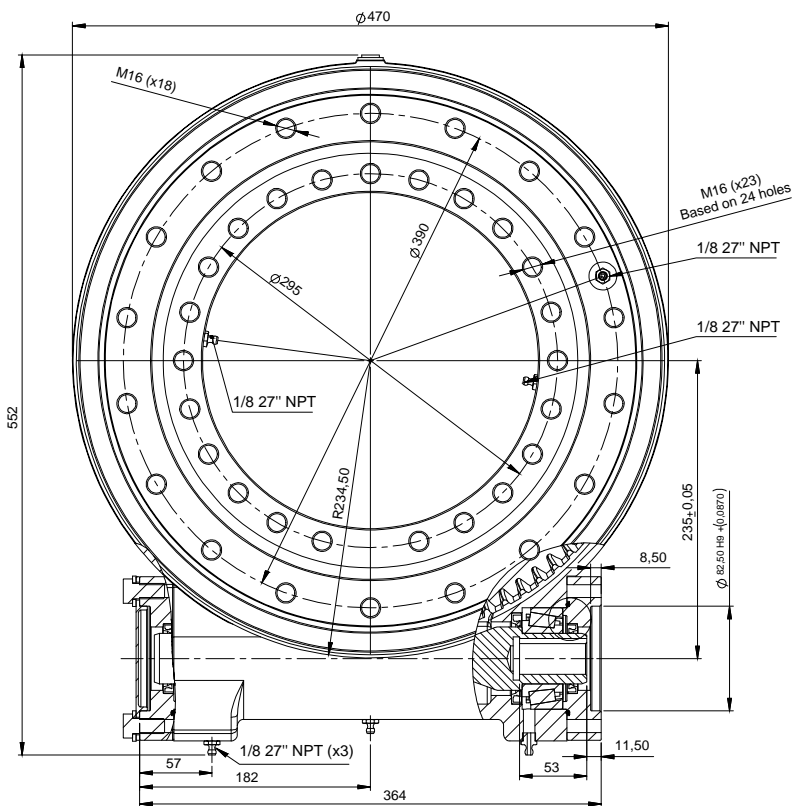
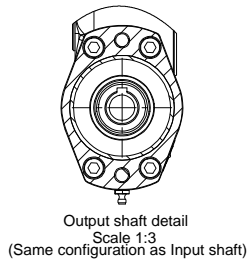
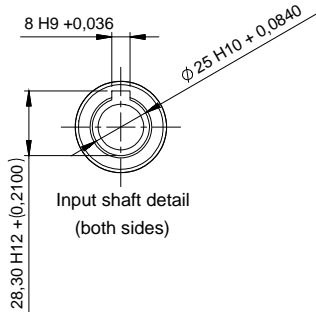

Note: Minimum input torque: 10Nm

Note: Minimum input torque: 10Nm

Main performance parameters

Gear Ratio	85:1	Holding torque	39kNm
Efficiency	40%	Tilting moment	75kNm
Self-locking gear	Yes	Radial static load	338kN
Backlash clearance	<0,17°	Axial static load	905kN
Maximum torque	12.308Nm	Radial dynamic load	157kN
Nominal torque	10.200Nm	Axial dynamic load	183kN

Notes: All slew drive are pre-lubricated. Maximum output speed 1rpm.

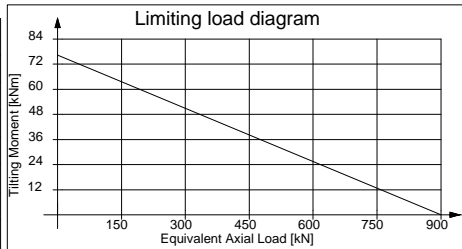

 KAVITSU GROUP OF INDUSTRIES Excellence in Gear Technology						Customer-Standard			Issued to -					
	Rev. no.		Revision note		Date	Signature	Checked	Limits	Designed by	Checked by	Approved by - date	Date	Material	Weight
	ARS		KVP		VGP		15.01.2022		C45		@77 Kgs.			
	Model Description KAVITSU ROBOTRONIX Pvt.Ltd.Satara					Layout no. SD-114-22.225-0345-FF			Qty. - 01 nos. KRPL-SD-010		Edition 0		Sheet 1/1	